



LOXLEY

ENGLAND

DEFENSORUM • ARTIS • PICTORIUM

Essex Easel (REF: EL-698)

GUIDE TO ASSEMBLY



Tilts forward!



Any working angle!



Horizontal set up!



Folds Flat!

- Maximum height: 70"
- Minimum height: 37"
- Base footprint 24"x28"
- Weighs 20 lbs
- Holds canvases up to 45" high

Hardware & Parts

- A** 1½" Allen/Hex Screws ×20
B 1½" Allen/Hex Screws ×4
C ½" wood screw ×12
D Pivot handle, washer and bolt ×2
E Brass pressure plate ×1
F Knob, washer and 2 ¼" bolt ×3
G Knob with attached bolt ×1
H Knob, channel slider and 2 ¼" bolt ×1
I Front legs (left and right) ×2
J Front leg cross bars (upper, lower) ×2
K Rear legs (left and right) ×2
L Rear leg cross bars (upper, lower) ×2
M Folding shelf with hinges attached ×1
N Canvas frame sides (left, right) ×2
O Canvas frame crossbars (upper, lower) ×2
P Center mast ×1
Q Top canvas holder mast ×1
R Bottom canvas holder mast ×1
S Back support bar ×1
T Allen/hex key

Phillips head screwdriver will also be needed.

*Carefully check the contents of the box to ensure all parts are included.
Be sure to read through and understand all steps before beginning.*

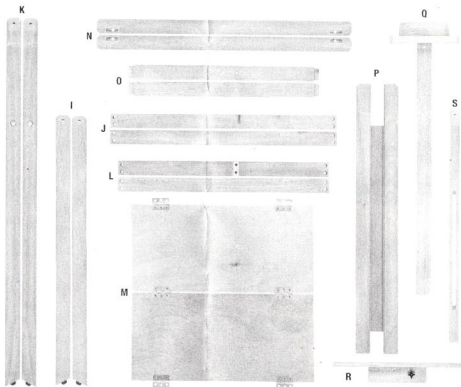
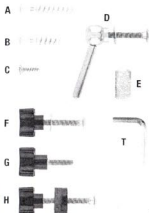

Essex Easel (REF: EL-698)

Assembly Instructions

STEP 1 REAR LEG ASSEMBLY

You will need: Parts A, K, L, T

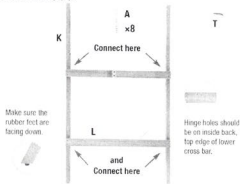

STEP 2 FRONT LEG ASSEMBLY

You will need: Parts A, I, J, T

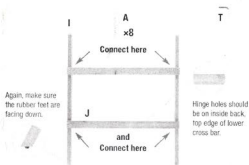

STEP 3 JOIN FRONT & REAR LEGS

You will need: Part F, assembled front legs and assembled rear legs



STEP 4 ATTACH SUPPORT SHELF

You will need: Parts C, M, Phillips head screwdriver

Attach the support shelf with hinges M as shown using twelve 1/2" wood screws C.

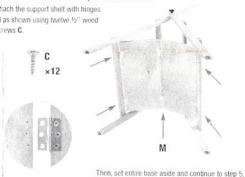

STEP 5 JOIN CANVAS FRAME

You will need: Parts A, N, O, E, T

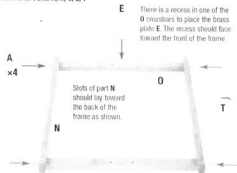

STEP 6 ATTACH CENTER MAST

You will need: Part B, G, T, assembled canvas frame

Flip entire frame over. Line up the holes in Part O with the holes in the back of Part P.

Be careful to keep the brass plate E in place.

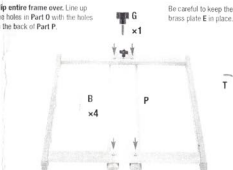

INSTRUCTIONS CONTINUED ON BACK PAGE

STEP 7 JOIN FRONT & REAR LEGS

You will need: Part D, assembled base, assembled canvas frame

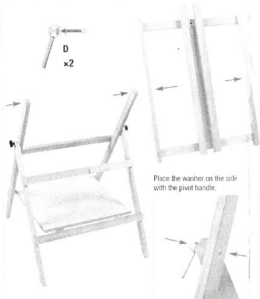

Place the washer on the side with the pivot handle.

STEP 8 INSERT TOP CANVAS HOLDER

You will need: Part G, Q, assembled easel

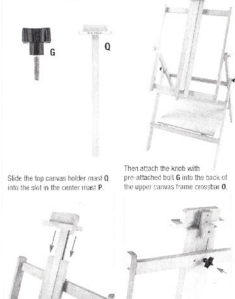

Slide the top canvas holder mast Q into the slot in the center mast P.

Then attach the knob with pre-attached bolt G into the back of the upper canvas frame crossbar O.

STEP 9 BOTTOM CANVAS HOLDER

You will need: Part R, assembled easel

Slide the bottom canvas holder R onto the center mast P from the bottom of the frame.

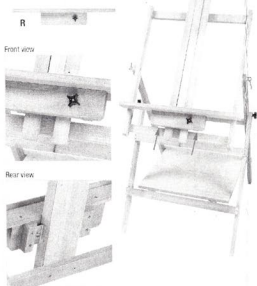

Front view

Rear view

STEP 10 ATTACH BACK SUPPORT BAR

You will need: Part F, H, S, assembled easel

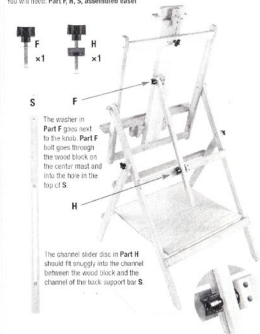

The washer in Part F goes next to the knob. Part F bolt goes through the wood block and into the hole in the top of S.

The channel slider disc in Part H should fit snugly into the channel between the wood block and the channel of the back support bar S.